



SCHWEIZER SERVICE BULLETIN

B-286
04 Oct 2006

MANDATORY

MANDATORY

MANDATORY

SUBJECT: TAIL ROTOR SWASHPLATE BELLCRANK ASSEMBLY SAFETY WASHER
INSTALLATION

MODELS AFFECTED:

- All 269A and 269B series helicopters.
- All 269C helicopters serial numbers 0001 thru 1893.

TIME OF COMPLIANCE: At next removal of tail rotor swashplate bellcrank assembly or 600 hour or 12 months from issue date of this Service Bulletin, whichever occurs first.

REFERENCE: 269A, TH-55A, A-1, B, and C Basic HMI or 269C 1809 & Sub. Basic HMI

PREFACE:

- A report has been received of loss of tail rotor control due to deterioration of a tail rotor swashplate bellcrank attachment bearing. This allowed a downward displacement of the bellcrank to a point that the bellcrank pivot pin disengaged the tail rotor swashplate pivot bearing. Installation of a large area AN970-5 washer as a safety washer will prevent a bellcrank displacement that can cause pivot pin disengagement. 269C helicopters serial numbers 1894 and subsequent have been delivered with the large area washer installed.
- Failure to comply with this Service Bulletin may lead to loss of control of the helicopter and subsequently cause serious injury, death and/or property damage.

APPROVAL: Engineering aspects of this Service Bulletin are FAA approved.

PARTS REQUIRED:

AN970-5	Washer
NAS6205-26D	Bolt
AN960KD516L	Washer (alternate AN960KD516) as required
AN320-5	Nut
MS24665-151	Cotter Pin

PROCEDURE:

- a. Inspect attachment bearing in tail rotor swashplate bellcrank assembly for security and condition in accordance with Basic HMI Section 9.
- b. Remove tail rotor swashplate bellcrank assembly from tail rotor transmission mount and discard NAS6205-25D bolt. Install bellcrank using NAS6205-26D bolt, AN970-5 large area washer, AN320-5 nut, and MS 24665-151 cotter pin. Use AN960KD516L or AN960KD516 washers as required to shim for clearance between bellcrank and transmission mount and AN970-5 washer as shown in Figure B-286-1.

WEIGHT AND BALANCE

Weight and Balance are not affected

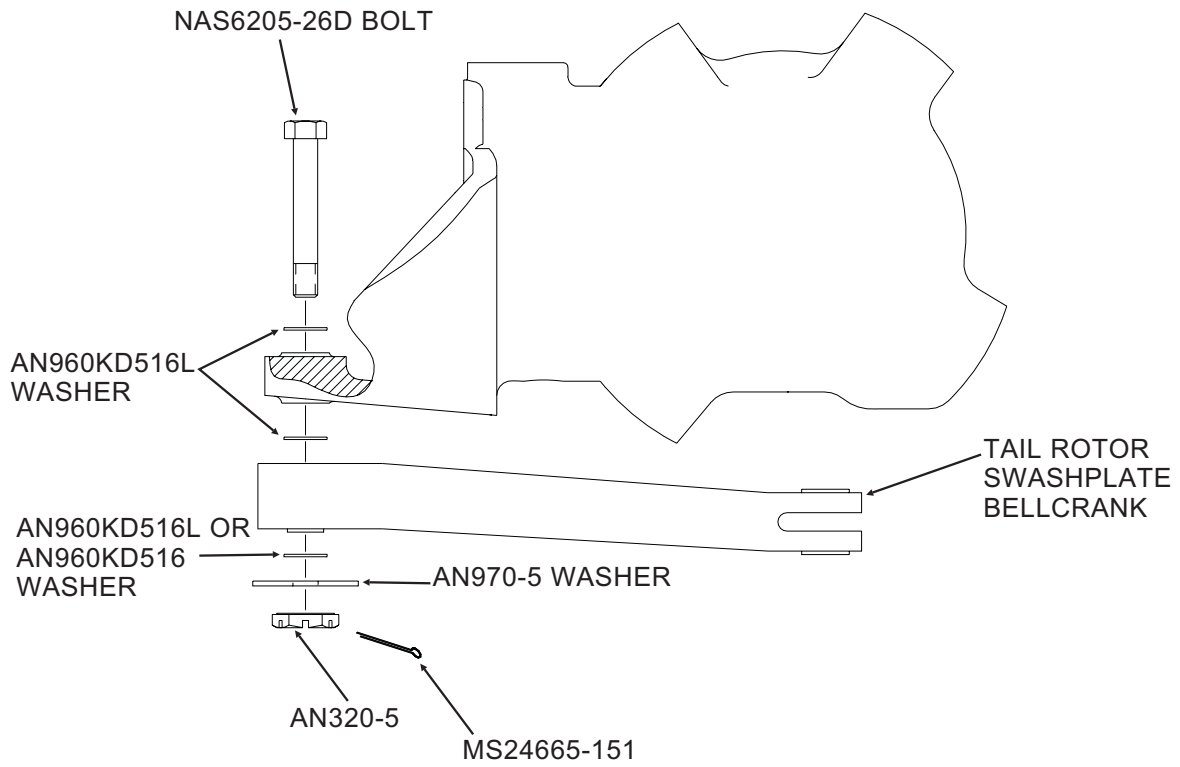

Figure B-286-1 Tail Rotor Transmission