



# SCHWEIZER SERVICE BULLETIN

C1B-019.1\*  
29 Jan 2007

MANDATORY

MANDATORY

MANDATORY

**SUBJECT:** TAIL ROTOR SWASHPLATE BELLCRANK ASSEMBLY SAFETY WASHER  
INSTALLATION

**MODELS AFFECTED:** All 269C-1 Model Helicopters serial numbers 0001 thru 0266.

**TIME OF COMPLIANCE:** At next removal of tail rotor swashplate bellcrank assembly or 600 hour or 12 months from issue date of this Service Bulletin, whichever occurs first.

**REFERENCE:** 269C-1 Basic HMI

- PREFACE:**
- A report has been received of loss of tail rotor control due to deterioration of a tail rotor swashplate bellcrank attachment bearing. This allowed a downward displacement of the bellcrank to a point that the bellcrank pivot pin disengaged the tail rotor swashplate pivot bearing. Installation of a large area AN970-5 washer as a safety washer will prevent a bellcrank displacement that can cause pivot pin disengagement. 269C-1 Model Helicopters serial number 0267 and subsequent have been delivered with the large area washer installed.
  - Failure to comply with this Service Bulletin may lead to loss of control of the helicopter and subsequently cause serious injury, death and/or property damage.

**APPROVAL:** Engineering aspects of this Service Bulletin are FAA approved.

<b>PARTS REQUIRED:</b>	AN970-5	Washer
	NAS6205-26D	Bolt
	AN960KD516L	Washer (alternate AN960KD516) as required
	AN320-5	Nut
	MS24665-151	Cotter Pin

**PROCEDURE:**

- Inspect attachment bearing in tail rotor swashplate bellcrank assembly for security and condition in accordance with Basic HMI Section 9.
- Remove tail rotor swashplate bellcrank assembly from tail rotor transmission mount and discard NAS6205-25D bolt. Install bellcrank using NAS6205-26D bolt, AN970-5 large area washer, AN320-5 nut and MS 24665-151 cotter pin. Use AN960KD516L or AN960KD516 washers as required to shim for clearance between bellcrank and transmission mount and AN970-5 washer as shown in Figure C1B-019-1.

(█) Denotes portion of text added or revised.

\*Supersedes C1B-019.1, dated 04 Oct 2006

WEIGHT AND BALANCE

Weight and Balance are not affected

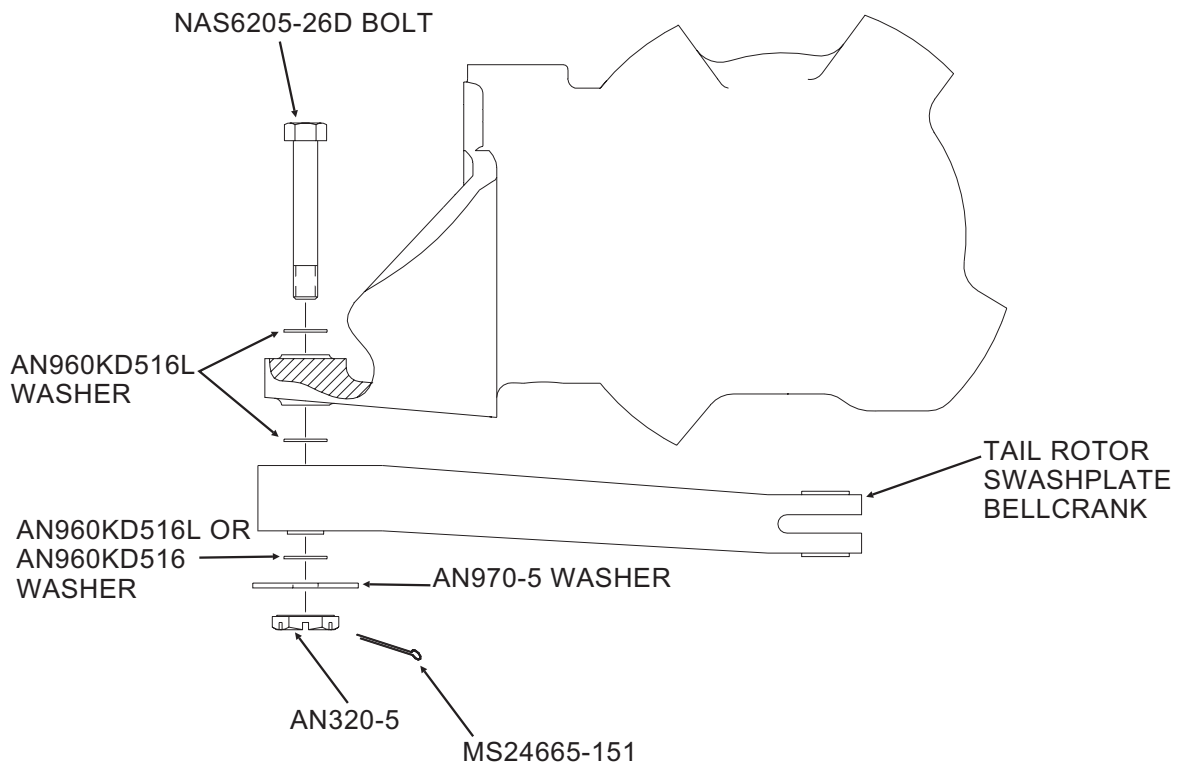

Figure C1B-019-1 Tail Rotor Transmission