

TOOLS & EQUIPMENT

Drill, portable	Commercial
Bit, ream - 0.4375/0.4380 in. dia.	Commercial
Vise, or equivalent	Commercial
Dye Check Kit	Commercial
Press, arbor	Commercial

- a. Remove alternator air duct; disconnect electrical plug and terminals on alternator.
- b. Remove attaching hardware at adjustment arm of alternator; remove drive belt from pulley.
- c. Remove lower scroll mounting bracket, bolt and attaching hardware from alternator mounting arm and engine bracket; remove alternator from aircraft.
- d. Secure alternator in vise or equivalent; ream hole through mounting arm to dimensions shown in Figure 1; using arbor press, install -3 bushing in mounting arm.

NOTE

Use dye check to inspect casting boss for cracks. If inspection reveals crack(s) in casting boss, replace alternator.

- e. Using arbor press install bushings in alternator bracket; install bushing in lower scroll mounting bracket; relieve holes as required.
- f. Reinstall alternator on engine mounting bracket and adjustment arm, using attaching hardware per Figure 1; do not torque bolts.
- g. Reinstall lower engine scroll mounting bracket.

NOTE

Shim with washers as required at bushing, per Figure 1, to align bracket.

- h. Position and secure alternator at adjustment arm to allow 5/16 inch deflection of drive belt; torque bolt in alternator mounting arm to 190-225 in. lbs.
- i. Reinstall alternator air duct; reconnect electrical plug and terminals.
- j. Check installation for discrepancies.
- k. Perform operational check of alternator.

WEIGHT & BALANCE DATA

Weight and balance not affected.

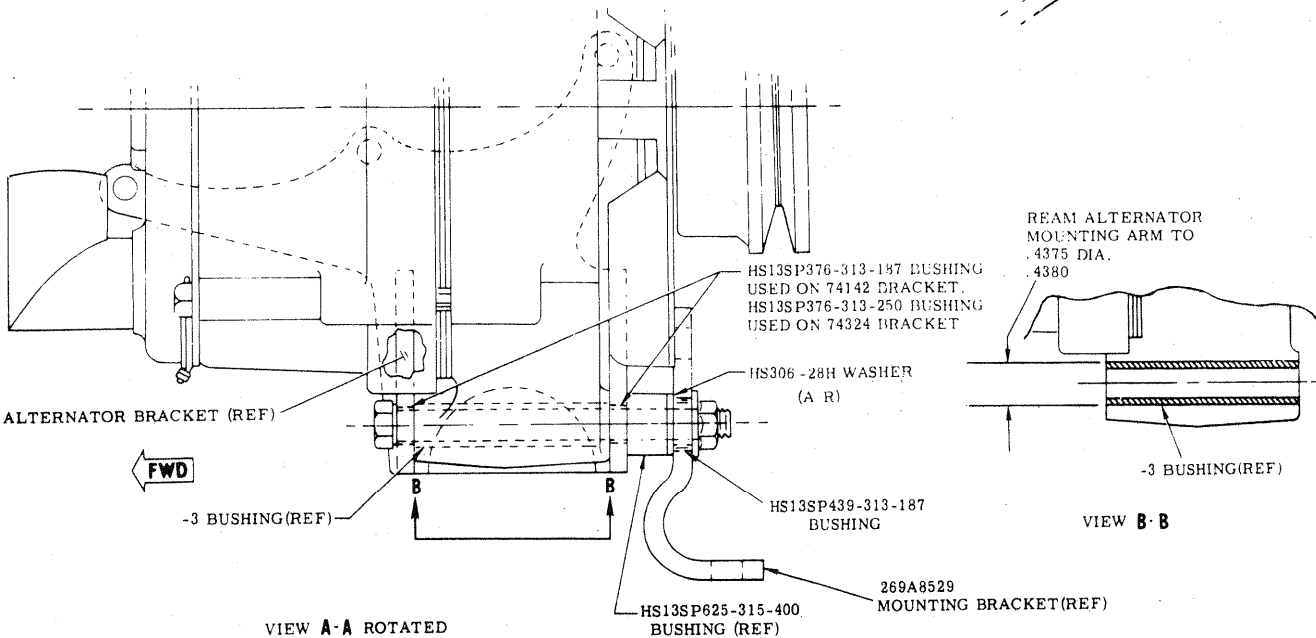
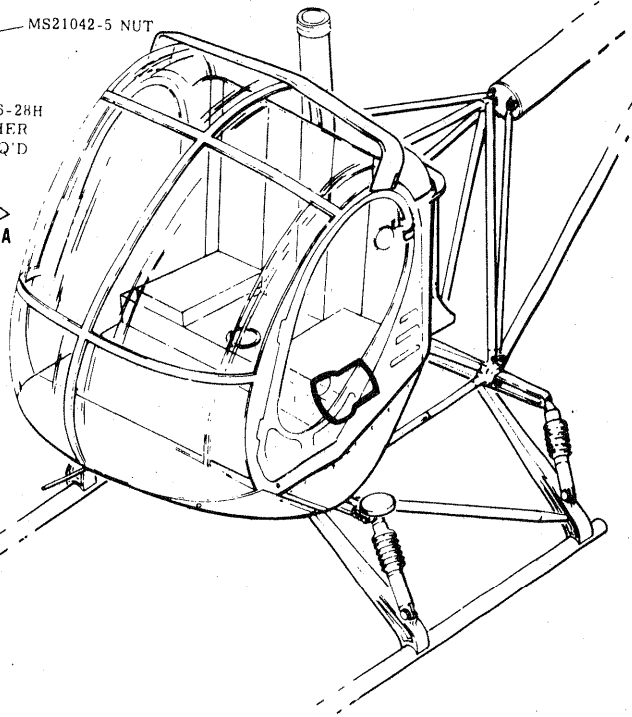
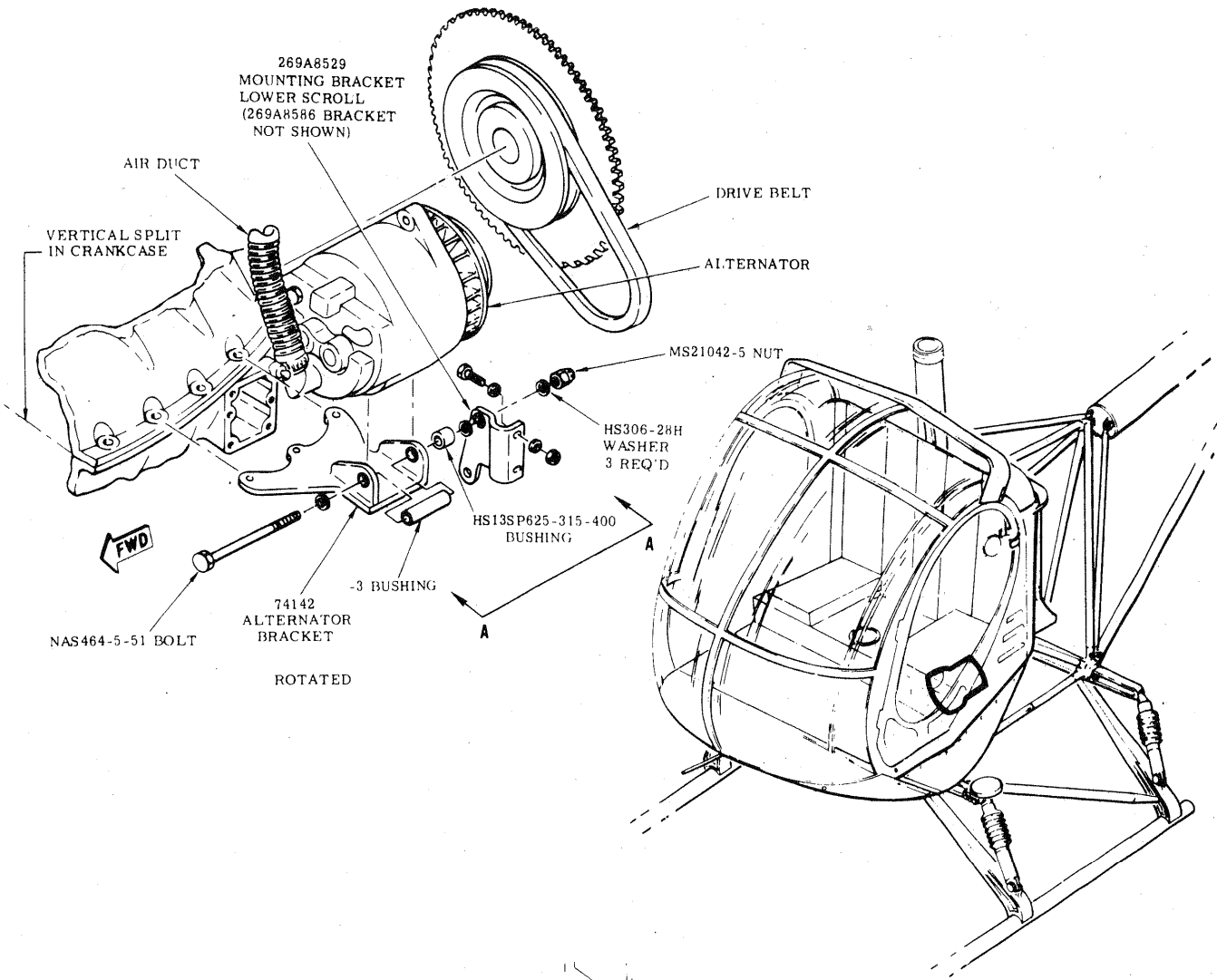

FIGURE 1. ALTERNATOR MOUNTING ASSEMBLY