



# SCHWEIZER SERVICE BULLETIN

C1B-024.1\*  
24 Nov 2008

**MANDATORY**

**MANDATORY**

**MANDATORY**

**SUBJECT:** THROTTLE CONTROL RESTRICTION

**MODELS AFFECTED:** 269C-1 helicopters serial numbers 0001 through 0345.

**TIME OF COMPLIANCE:** Within next 100 hours of operation or within 6 months whichever occurs first.

**REFERENCE:** 269C-1 Basic HMI, Revised: 14 Nov 2008.

**PREFACE:** • During routine maintenance, a throttle control restriction can occur if the flight control cover in the center of the seat back is reinstalled incorrectly. Installation of a 90° angle tab on the center cover support bracket will prevent the edge of the flight control cover from being placed between the support bracket and the throttle bellcrank during cover installation. Helicopter serial numbers 0311 and subsequent have the tab installed. Also, installation of a blind nut and screw in all the affected serial numbers above will assure the cover is installed and secured in the proper position.

**WARNING**

**FAILURE TO COMPLY WITH THIS SERVICE BULLETIN MAY LEAD TO A THROTTLE RESTRICTION THAT MAY SUBSEQUENTLY LEAD TO AN ENGINE AND ROTOR OVERSPEED. A ROTOR OVERSPEED THAT IS UNCONTROLLED BY THE PILOT MAY ULTIMATELY LEAD TO STRUCTURAL FAILURE OF THE ROTOR AND SUBSEQUENT SERIOUS INJURY, DEATH, AND/OR PROPERTY DAMAGE.**

**FAA APPROVAL:** The technical aspects of this Service Bulletin are FAA approved.

**PARTS REQUIRED:** Procure following from local source:

.040 inch thick 2024-T3	Aluminum	As required
CR2249-4 (Alt. NAS1738B4)	Rivets	2 Each
* S10K80 (Alt. NAS1329S3K80)	Blind Nut	1 Each
AN525-10-7 (Alt. MS35207-264)	Screw	1 Each
AN960KD10L (Alt. NAS1149D0316H)	Washer	1 Each

\* S10K80 Blind Nut (Rivnut) is manufactured by B.F. Goodrich Aerospace, Everett WA.

**PROCEDURE:**

- a. Remove bottom seat cushions and panels securing center flight control cover in position. Remove center flight control cover from seat back.

( | ) Denotes portion of text added or revised

\*Supersedes C1B-024, dated 14 Jul 2008

NOTE

In the following step, helicopter serial numbers 0144 through 0310 were equipped with center cover support brackets with a top flange of 0.19 to 0.25 inch wide. Helicopters in this serial number group or any that have flanges modified to a dimension less than 0.60 inch, require installation of a 90° angle tab.

- b. Measure flange on top edge of center cover support bracket as shown in Figure C1B-024-1. If flange is less than 0.60 inch wide, Fabricate a 90° angle tab to dimensions shown in figure. Place angle tab in position with flange flush against lower edge of support bracket. Using number 27 drill, drill two rivet holes in locations shown in figure and secure angle bracket to support bracket using CR2249-4 rivets.

NOTE

All 269C-1 model helicopters up to serial number 0319 require installation of the blind nut. The flange on the bottom edge of the center cover support bracket is riveted to the seat structure on the spot weld line of an internal longitudinal seat frame. In the next step, the blind nut will be installed in the same spot weld line.

- c. Select a spot weld that is approximately 1 inch forward of forward edge of bottom flange of support bracket (Fig. C1B-024-1). Drill a .250 to .256 inch hole in center of selected spot weld and make a key slot in edge of hole to accommodate key of blind nut. Install S10K80 blind nut in hole.
- d. Install and secure center flight control cover in position. Using a hole finder centered on blind nut, drill a .190 to .195 inch hole in flange of cover. Secure cover flange to seat bench with AN525-10-7 Screw and AN960KD10L Washer.
- e. Check throttle for freedom of movement and no interference.
- f. Reinstall all removed panels and seat cushions.
- g. Record compliance with this Service Bulletin in the aircraft records.

WEIGHT AND BALANCE

Weight and Balance are not affected

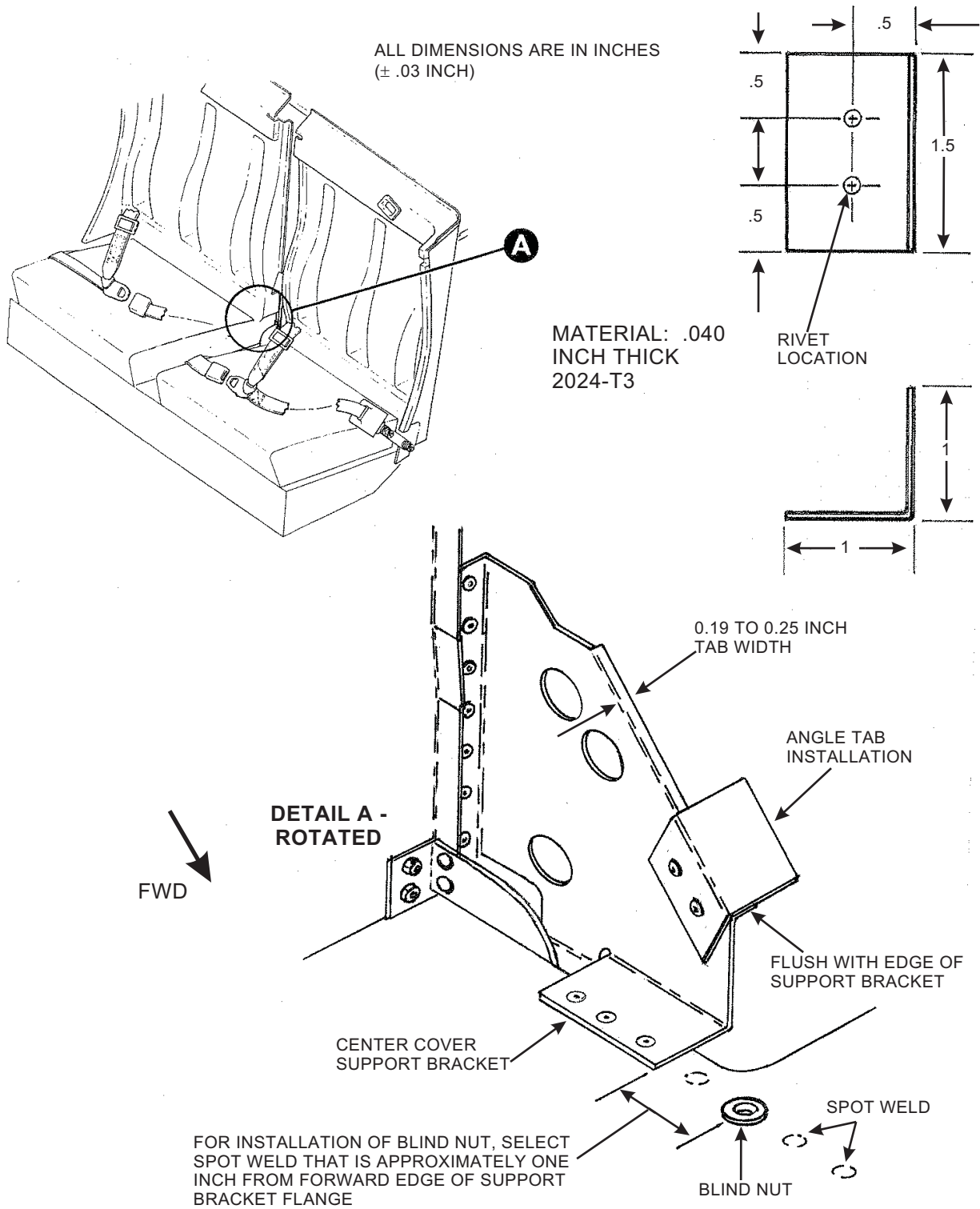

Figure C1B-024-1. Angle Tab Installation

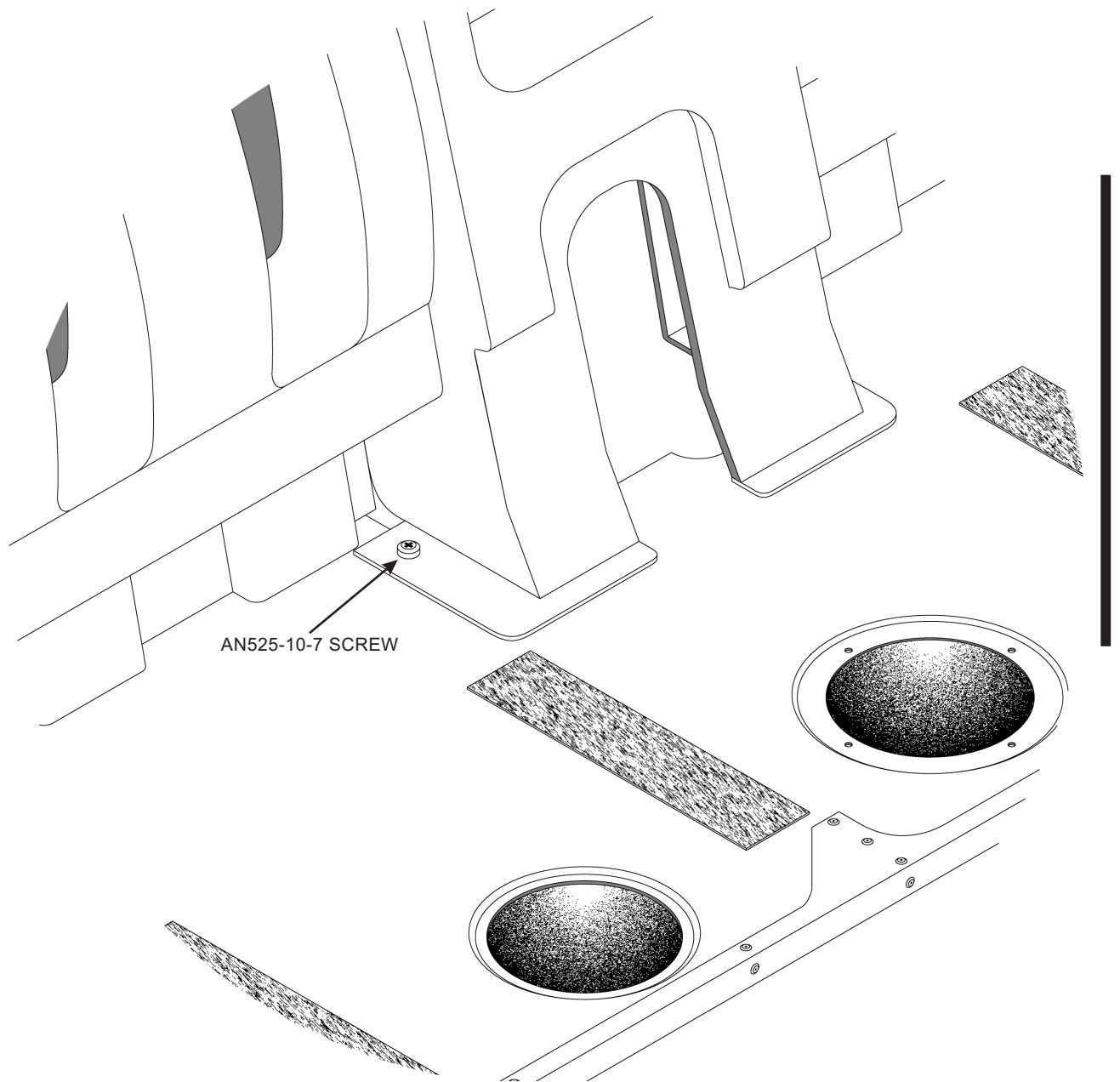

Figure C1B-024-2. Throttle Control Restriction