



# SCHWEIZER SERVICE INFORMATION NOTICE

NOTICE NO. N-79

DATE September 4, 1970

PAGE 1 OF 5

SUBJECT: RELOCATION - OIL PRESSURE SENDER (#5654912)  
AND FUEL PRESSURE SENDER (#5654913)

MODELS AFFECTED: The following helicopters equipped with subject  
sending units:

269A Helicopter Serial Nos. 0011 thru 1109  
269B Helicopter Serial Nos. 0001 thru 0460  
269C Helicopter Serial Nos. 0001 thru 0016

TIME OF COMPLIANCE: At owners and operators discretion

PREFACE: The information given in this Service Information Notice lists a  
procedure for removal of the fuel pressure sender and oil  
pressure sender from existing locations on the helicopter engine,  
and relocation of these units on the helicopter frame structure to  
reduce failure of the sending units due to vibration.

## Reference

269A/A-1/TH-55A Handbook of Maintenance Instructions, Revised 15 March 1969

269B Handbook of Maintenance Instruction, Revised 1 January 1970

269C Handbook of Maintenance Instruction, Issued 1 September 1969

PARTS LIST

<u>Nomenclature</u>	<u>Part No.</u>	<u>Qty.</u>	<u>Source</u>
<u>For Fuel Pressure Sender Relocation:</u>			
Hose Assembly	269A8327-23	1	HTC-AD
Connector	4-37-3	1	Commercial
Elbow (90 <sup>0</sup> ) (269A and 269B)	4-SA-6	1	Commercial
Elbow (45 <sup>0</sup> ) (269C only)	4-SA-5	1	Commercial
Bolt	AN-3-4A	1	Commercial
Clamp	AN742-H26	1	Commercial
Washer	AN960PD10L	2	Commercial
Nut	MS20365-1032	1	Commercial
<u>For Oil Pressure Sender Relocation:</u>			
Hose Assembly	269A8327-147	1	HTC-AD
Connector	4-37-7	1	Commercial
Elbow (45 <sup>0</sup> )	AN823-4D	1	Commercial
Bolt	AN3-5A	2	Commercial
Clamp	AN735-12	1	Commercial
Clamp	AN742-H26	1	Commercial
Bracket	AN743-12	1	Commercial
Washer	AN960PD10L	2	Commercial
Nut	MS20365-1032	2	Commercial

PREPARATION

- a. Check all cockpit switches for OFF position.

NOTE: Pay particular attention to MAG switch.

- b. Disconnect battery cables.
- c. Remove lower fairing.

RELOCATION - OIL PRESSURE SENDER #5654912

- a. Remove hardware securing oil pressure sender to bracket on engine accessory case.
- b. Remove connector and elbow securing existing tube assembly to oil pressure sender and engine firewall.
- c. Install new 269A8327-147 hose assembly and #4-37-7 connector to oil pressure sender.
- d. Install oil pressure sender on helicopter frame structure, using clamps, bracket, and attaching hardware as shown in Figure 1. When installing clamp on frame tube, remove existing finish to bare metal to ensure proper ground.
- e. Install new -147 hose assembly and AN823-4D elbow on engine firewall; position elbow so that hose does not rub frame.
- f. Tie any excess wiring for sending unit into existing wire harness.

RELOCATION - FUEL PRESSURE SENDER #5654913

- a. Remove hardware securing fuel pressure sender to bracket on engine accessory case; remove bracket from engine accessory case; reinstall existing bolts.

NOTE: Fuel pressure sender is mounted directly on fuel injector, for early configuration Model 269C helicopters.

- b. Remove existing fittings, and tube assembly as applicable, securing fuel pressure sender to carburetor or fuel injector.
- c. Install new 269A8327-23 hose assembly and #4-37-7 connector to fuel pressure sender.

NOTICE NO. N-79

DATE September 4, 1970

PAGE 4 of 5

d. Install fuel pressure sender on 269A2251 beam, using clamps and attaching hardware, as shown in Figure 1. When installing clamp on beam, remove existing finish to bare metal to ensure proper ground.

e. Install new -23 hose assembly and elbow to carburetor or fuel injector; position elbow, as required, so that hose is free of throttle arm and port nozzles.

f. Tie any excess wiring for sending unit into existing wire harness.

g. Connect BATTERY.

#### OPERATIONAL CHECK

a. Check installation of relocated pressure sending unit(s) for discrepancies.

b. Start engine and check fuel pressure and oil pressure gages for proper readings. (Refer to Owners Flight Manual)

c. Shut down engine.

d. Install lower forward fairing.

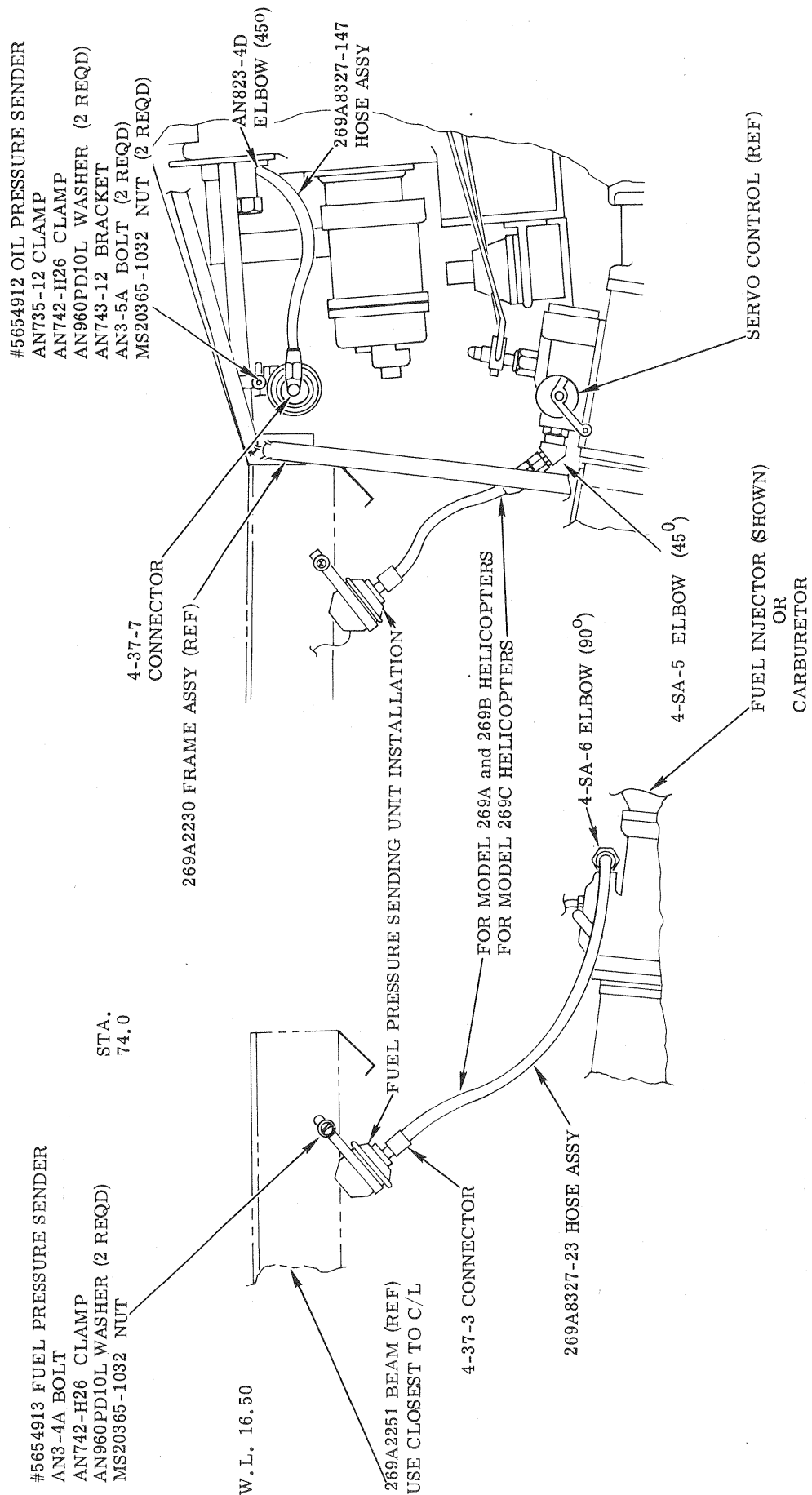

FIGURE 1. RELOCATION - OIL PRESSURE SENDER AND FUEL PRESSURE SENDER

